

Gila County Bond Referendum - November 2007

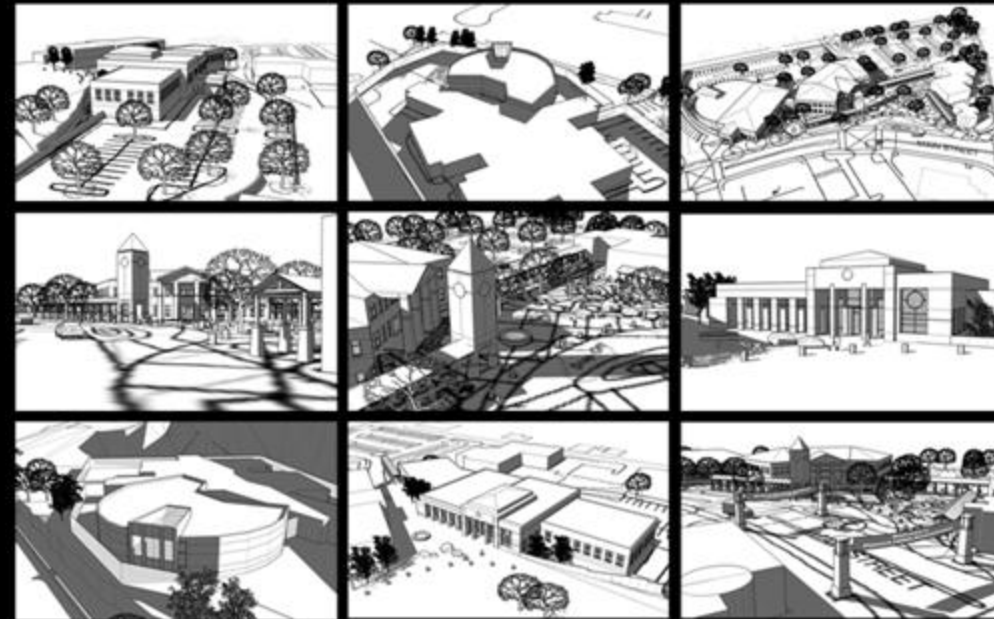



Existing Chamber of Commerce



Existing Administration Center



- The expanded Payson County Criminal Justice Center is to be located on the existing site, Main Street and State Route 87. The complex is intended to include Justice of the Peace/Superior Court Rooms and their support spaces, offices for the County Attorney, Constable, Sheriff's Administration and detention.
- Long-term planning requires acquisition of additional land for development of a cohesive campus, central plaza and a community gathering place for the Town.
- Site development will provide safer movement of traffic on the streets in the vicinity of the project. Colcord Street will be abandoned and this area used to create the "civic plaza." The northern edge of the site along Frontier Street will be configured to increase right-of-way for two-way traffic and ease traffic congestion. On the west end, Tonto Street will connect Frontier to Main Street.



Cottage to be acquired

The rustic cottage which currently faces on Main Street and is west of the Jail will be relocated further to the west. This will preserve the historical importance of the structure and provides a natural extension to historic Main Street. In its new location current options are to use renovated space for the Payson Regional Chamber of Commerce, or other County functions. As a part of the overall site re-development, the existing Chamber building is projected for County administrative functions.



Jail Facilities along Colcord

Colcord R.O.W. to be abandoned



0 50 100

Gila County
Bond Referendum - November 2007
Payson

Criminal Justice Center





For over 5,000 years development of the successful city has featured a public plaza, square, green or court. Usually identified by one or more towers, steeples or other vertical elements these gathering places serve as the essential starting point for visitors to a town. The courthouse square is familiar to most people in downtown or the center of the city. Important public events occur "on the steps of the courthouse" as the focus of the square.

Recognition of the vital importance and need for a central public space is the basis for the concept of the Payson Civic Plaza on Main Street.

- Approximately 58,000 square foot split level Criminal Justice Center.
- Designed to complement Payson's "Historic" Main Street and the Town's image as a "Mountain Town with a Western Heritage."
- Establishes a civic identity and a heart for the Town.
- A two-story, 32,000 square foot "podular" detention facility with interior day rooms, a screened exercise area and central control room.
- The detention facility will be "hidden" by integrating it into the slope of the site.
- All prisoner movement on site will be invisible to the public with a secure sallyport and connected passage-way between jail and court.
- Secure parking areas for Court personnel and Sheriff's vehicles will be accessed through monitored vehicular gates.



Gila County
Bond Referendum - November 2007
Payson



0 50 100



Criminal Justice Center





Strategically located at the east end of Main Street, the Plaza will become the "Gateway" to the Town/historic Main Street, and help anchor the "entertainment triangle" (Green Valley Redevelopment Area). Adjacent to the Plaza, gateway pylons are being considered to frame the view down the street. Strung from pylon-to pylon and draped above the street changeable banners will announce events on Main Street; Rodeo Days, festivals, car shows, arts and crafts fairs or other local community events.

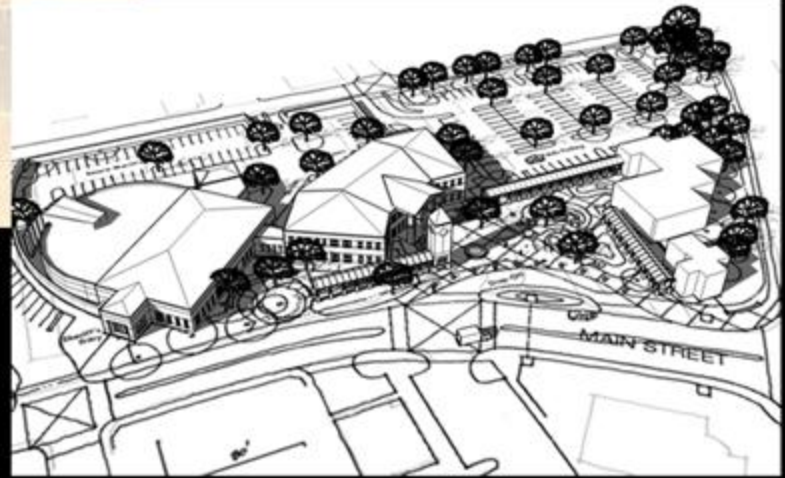
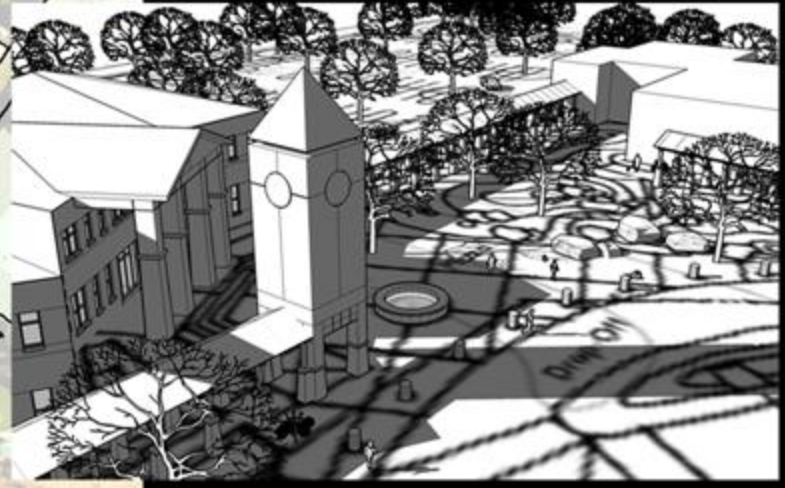
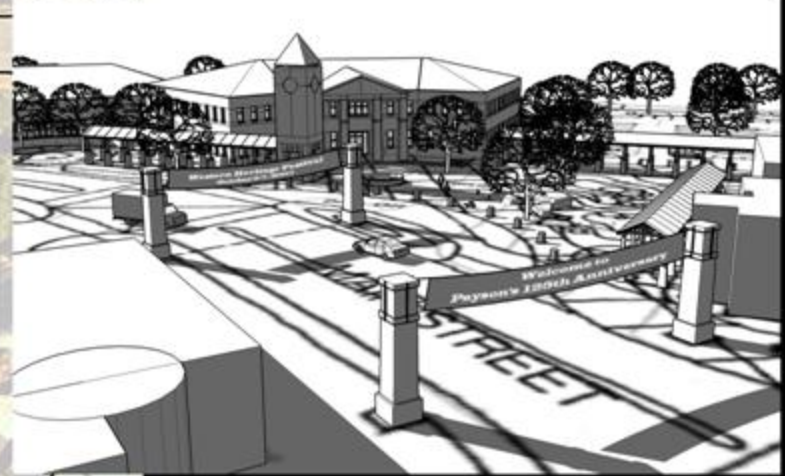

- In place of the Colcord Street right-of-way a grand public Plaza will be developed to serve as a connecting space between the new Criminal Justice Center's entry and the entry court of the existing County Administrative Center.
- The Plaza will provide a venue for a variety of civic and social activities such as fairs, festivals and other fun events in the town. The vision includes a mixture of places for both intimate and large gatherings and will accommodate two or two hundred people!
- Larger public events that occur on weekends or holidays will be served by over one hundred parking spaces located immediately to the north of the plaza.
- Colonnaded walkways connect the parking areas and buildings and also provide covered areas for visitors to meet, mingle and relax in the shade while enjoying a little "people-watching."
- The Plaza is intended to be created with a series of outdoor spaces that are delightful on their own merits with trees, rocks, landscaped berms and planters to deliver inviting spaces for personal interaction.
- The Plaza will be a community focal point, a cradle for true and vibrant public life in Payson.

Bond Referendum - November 2007

Payson

Criminal Justice Center

